

Connector Unit

CUCB



Technical Data	Unit	D-Line	C-Line	B - Line	A-Line
Nominal current	A	160	200	250	250 315 400 500 600
Rated current	A	160	250	285	315 380 450 500 600
Rated voltage	V	690			
Rated ultimate short-circuit breaking capacity I _{cu} (400V)	kA	36			
Thermo magnetic current setting range	A	160	200	250	250 315 400 500 600
Rated frequency	Hz	50 / 60			
Withstand voltage (1 Min / 50 Hz)	V	3'000			
Protection grade		IP 54			
Shock resistance		IK 07			
Ambient temperature	°C	-40 / +70			
Insulation resistance (phase to phase and phase to earth)	MOhm	> 500			
Comparative tracking index of the insert	CTI	> 600			
Weight 4-pol. (3L+PEN)	kg	25.1		45.6	
Weight 5-pol. (3L+N+PE)	kg	25.3		47.1	
Connection bolts for cable shoes		M10			
Max. cross section pilot cable, conductor (EN 60228 Class 1)	mm ²	4			
Diameter of cable - normal other diameters on request	mm	20 - 70			

Technical modifications reserved

Structure

Locking system

A circuit breaker is installed in the CUCB connector unit. During every plug-in operation, the standardly installed pilot contacts in the connector transmit a signal to the circuit breaker.

The main contacts in the connector unit can be manually closed via the switch afterwards. Thus the connection is under load.

In addition, the CUCB has an overload protection device, which safely disconnects the connection even in the event of damage to other connected devices.

On request, a residual current circuit breaker „RCD“ is also available.

Construction of a CUCB connection box

1. Cable gland
2. Switch
3. Panel Mounted Receptacle

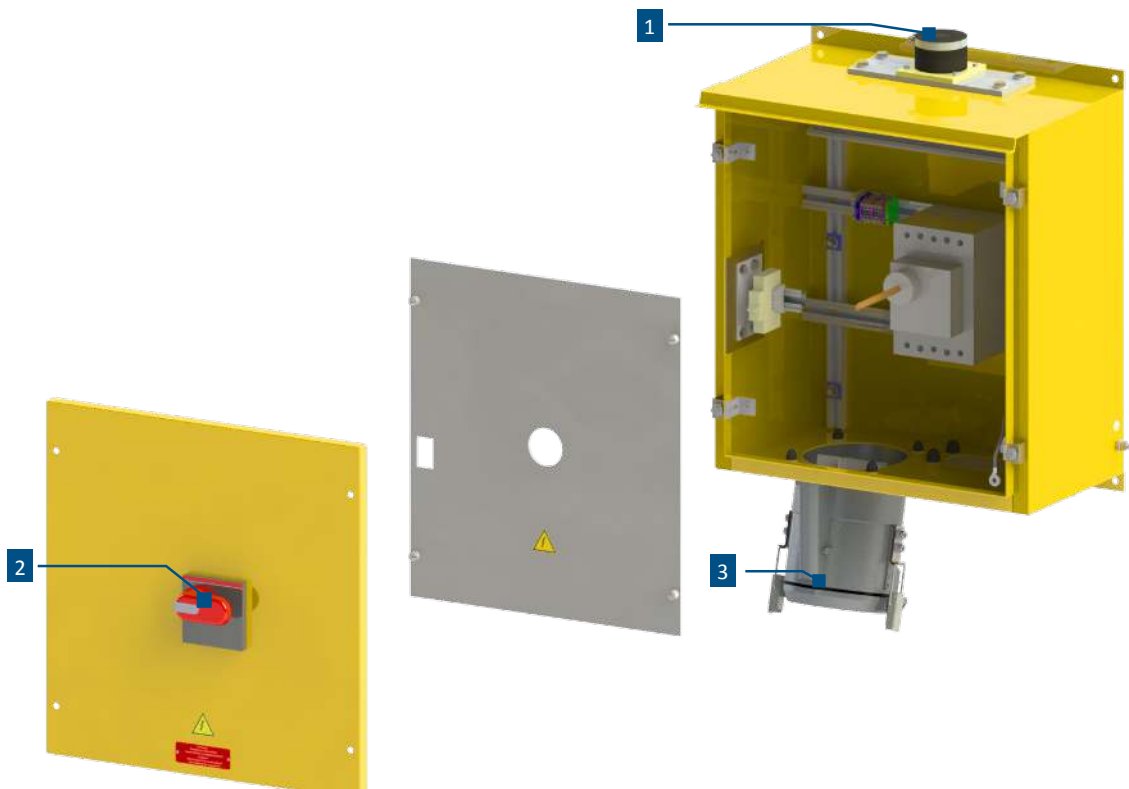

CUCB D - Line

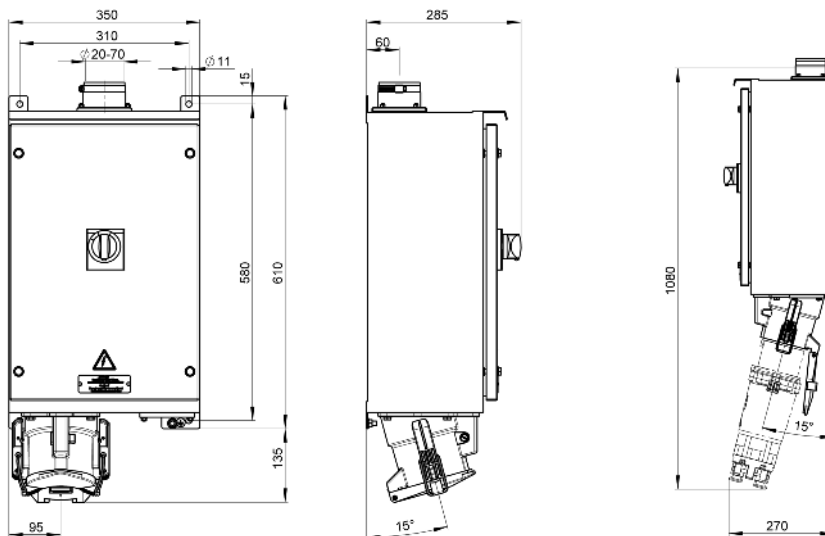

Current	No. of Poles	Voltage	Type designation	Article No.
160 A	4 (3L+PEN)	230V	CUCB-S4/160 230V-9h	25420
		400V	CUCB-S4/160 400V-6h	25421
		500V	CUCB-S4/160 500V-7h	25422
		690V	CUCB-S4/160 690V-5h	25423
	5 (3L+N+PE)	230V	CUCB-S5/160 230V-9h	25435
		400V	CUCB-S5/160 400V-6h	25436
		500V	CUCB-S5/160 500V-7h	25437
		690V	CUCB-S5/160 690V-5h	25438

CUCB C - Line

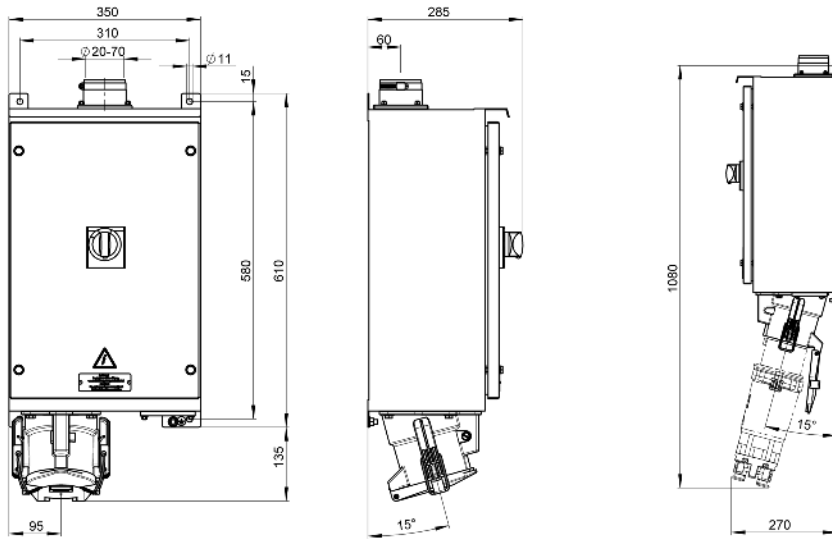

Current	No. of Poles	Voltage	Type designation	Article No.
200 A	4 (3L+PEN)	230V	CUCB-S4/200 230V-9h	17360
		400V	CUCB-S4/200 400V-6h	17361
		500V	CUCB-S4/200 500V-7h	17362
		690V	CUCB-S4/200 690V-5h	17363
	5 (3L+N+PE)	230V	CUCB-S5/200 400V-6h	17365
		400V	CUCB-S5/200 500V-7h	17366
		500V	CUCB-S5/200 690V-5h	17367
		690V	CUCB-S4/250 230V-9h	17368
250 A	4 (3L+PEN)	230V	CUCB-S4/250 500V-7h	22180
		400V	CUCB-S4/250 690V-5h	22181
		500V	CUCB-S5/250 230V-9h	22182
		690V	CUCB-S5/250 400V-6h	22183
	5 (3L+N+PE)	230V	CUCB-S5/250 690V-5h	22185
		400V	CUCB-S5/250 400V-6h	22186
		500V	CUCB-S5/250 500V-7h	22187
		690V	CUCB-S5/250 690V-5h	22188



CUCB B - Line

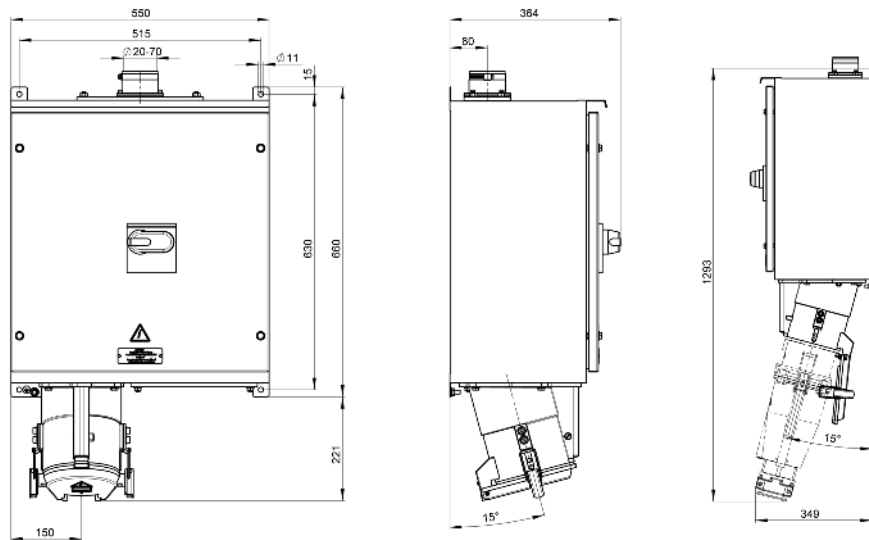

Current	No. of Poles	Voltage	Type designation	Article No.
250A	4 (3L+PEN)	230V	CUCB-S4/250 230V-9h	17370
		400V	CUCB-S4/250 400V-6h	17371
		500V	CUCB-S4/250 500V-7h	17372
		690V	CUCB-S4/250 690V-5h	17373
	5 (3L+N+PE)	230V	CUCB-S5/250 400V-6h	17375
		400V	CUCB-S5/250 500V-7h	17376
		500V	CUCB-S5/250 690V-5h	17377
		690V	CUCB-S4/315 230V-9h	17378
315 A	4 (3L+PEN)	230V	CUCB-S4/315 500V-7h	22980
		400V	CUCB-S4/315 690V-5h	22981
		500V	CUCB-S5/315 230V-9h	22982
		690V	CUCB-S5/315 400V-6h	22983
	5 (3L+N+PE)	230V	CUCB-S5/315 690V-5h	22984
		400V	CUCB-S4/400 230V-9h	22985
		500V	CUCB-S4/400 400V-6h	22986
		690V	CUCB-S4/400 500V-7h	22987
400 A	4 (3L+PEN)	230V	CUCB-S5/400 230V-9h	17380
		400V	CUCB-S5/400 400V-6h	17381
		500V	CUCB-S5/400 500V-7h	17382
		690V	CUCB-S5/400 690V-5h	17383
	5 (3L+N+PE)	230V	CUBC-S5/400 230V-9h	17385
		400V	CUBC-S5/400 400V-6h	17386
		500V	CUBC-S5/400 500V-7h	17387
		690V	CUBC-S5/400 690V-5h	17388

CUCB A - Line

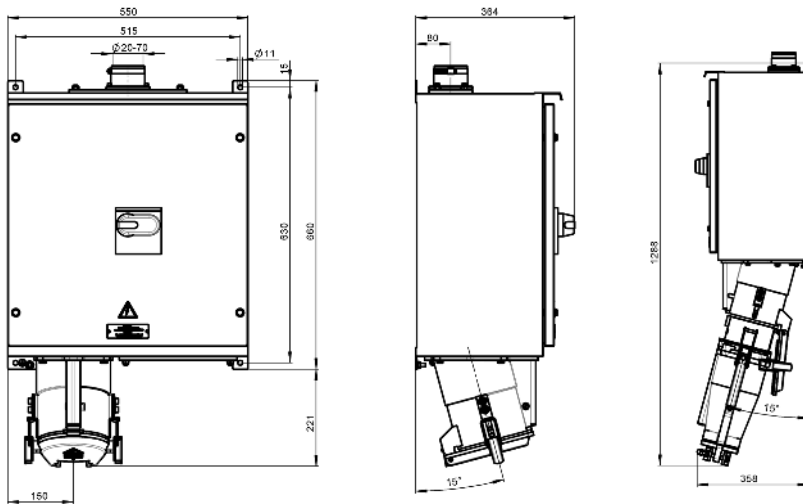

Current	No. of Poles	Voltage	Type designation	Article No.
500 A	4 (3L+PEN)	230V	CUCB-S4/500 230V-9h	25425
		400V	CUCB-S4/500 400V-6h	25426
		500V	CUCB-S4/500 500V-7h	25427
		690V	CUCB-S4/500 690V-5h	25428
	5 (3L+N+PE)	230V	CUCB-S5/500 230V-9h	25440
		400V	CUCB-S5/500 400V-6h	25441
		500V	CUCB-S5/500 500V-7h	25442
		690V	CUCB-S5/500 690V-5h	25443
600 A	4 (3L+PEN)	230V	CUCB-S4/600 230V-9h	25430
		400V	CUCB-S4/600 400V-6h	25431
		500V	CUCB-S4/600 500V-7h	25432
		690V	CUCB-S4/600 690V-5h	25433
	5 (3L+N+PE)	230V	CUCB-S5/600 230V-9h	25445
		400V	CUCB-S5/600 400V-6h	25446
		500V	CUCB-S5/600 500V-7h	25447
		690V	CUCB-S5/600 690V-5h	25448

